

NOTE:  
ALL DIMENSIONS  
IN INCHES  
[ALTERNATE IN METRIC]

DIRECTION OF VEHICLE ATTACK

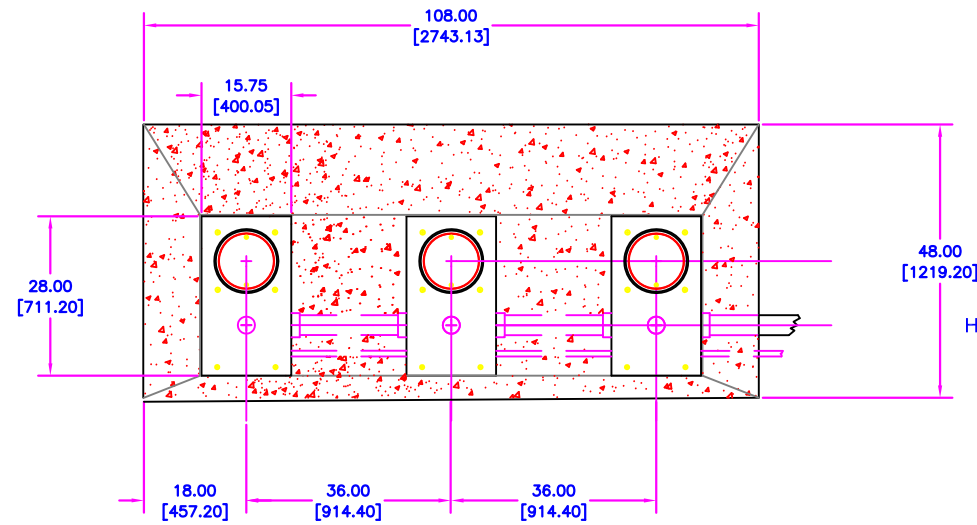

TOP (PLAN) VIEW

DIRECTION OF VEHICLE ATTACK

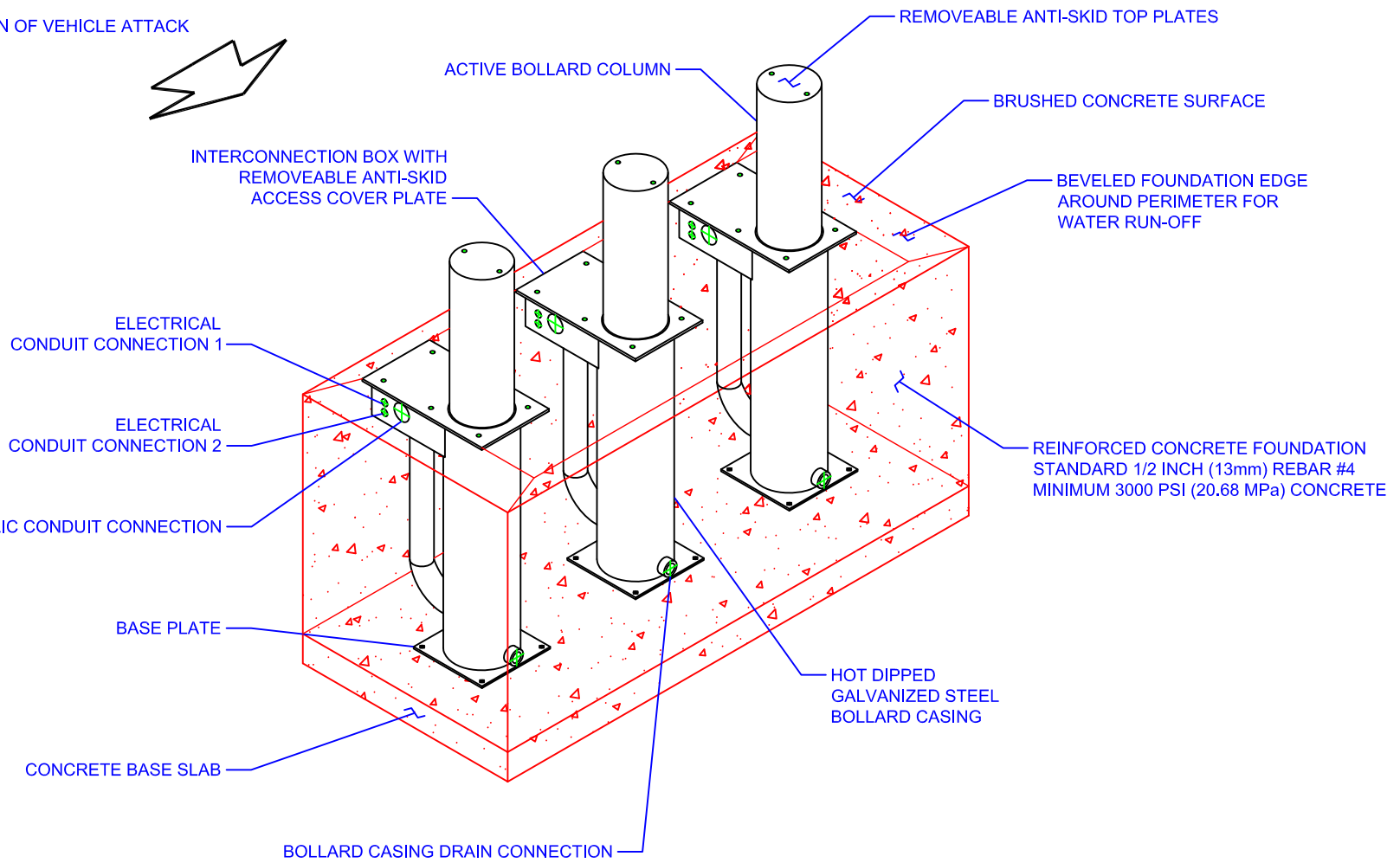
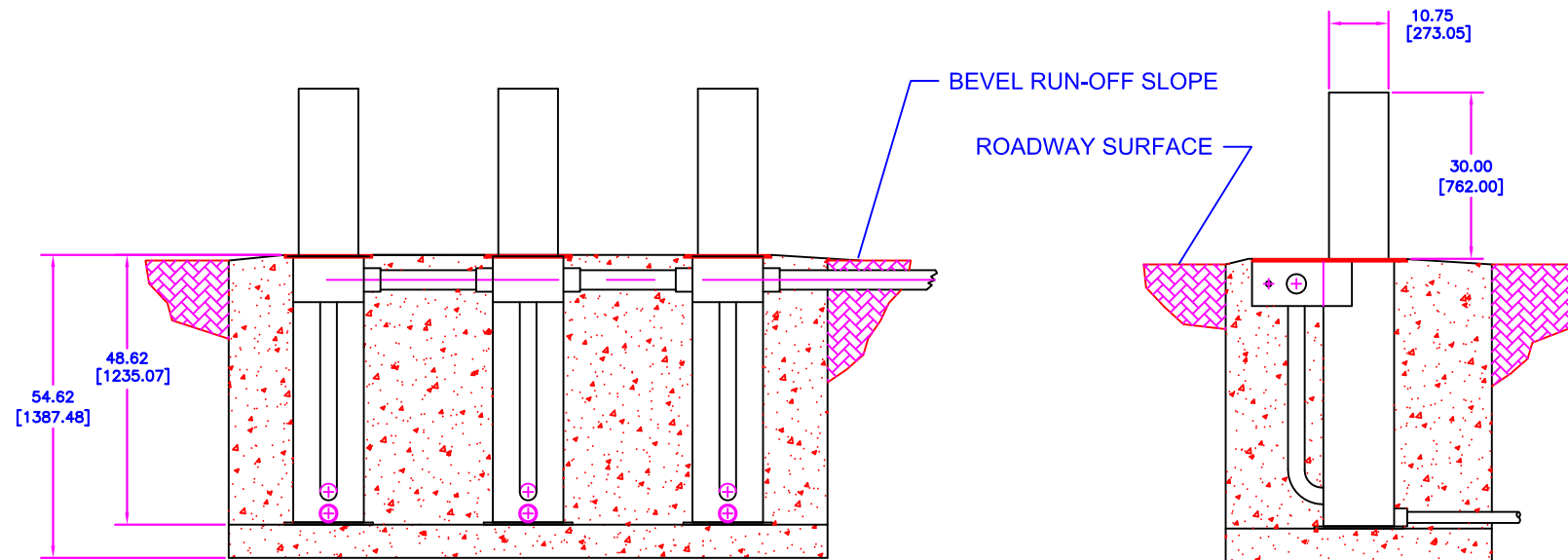

Notes:

1. The Defender is K4 certified by the U.S. Department of State (DOS).
2. Standard DOS crash rating bollard spacing is not to exceed 36 inches [914mm].
3. Standard configuration with 3 bollards shown. Additional bollard configurations are available.
4. Outer casings are standard hot dipped galvanized for corrosion protection.
5. Black paint is standard. Custom specified paint colors are available
6. Heaters are available for cold weather applications.
7. Hydraulic Power Unit (HPU) and Operator Control Panels are not shown.
8. Weather-proof HPU enclosure is standard.
9. Traffic signal lights, warning lights, vehicle detector loops, and other accessories are available.
10. Construction and installation by others, such as concrete foundation, rebar, roadway surface, conduit, wiring and hydraulic hoses.

<small>PROPRIETARY INFORMATION</small> This drawing is the proprietary property of AMERISTAR, Tulsa, OK and must not be duplicated or used in whole or in part for the making of drawings, prints or parts to the detriment of, or harm to, the owner. In accepting this drawing, the recipient agrees to keep the information contained confidential.			1555 N. Mingo Tulsa, OK 74116 1-888-333-3422 www.ameristarfence.com
	TITLE: DEFENDER 4 VIEW		
	DATE:	SCALE:	SHEET: 1/1
	DRN BY:	CHK BY: xxxxxxxx	REV: a
DRAWING NO:			